

Q1 2021

ALR New Product LookBook

Table of Contents

Decorative
Architectural
Downlights and Track
Specialty
Outdoor

DECORATIVE



Flora Collection from Alora

- Family of chandelier, pendants, and wall sconce
- Natural brass finish
- TRIAC/ELV dimmable to 10%, 3000k only
- Clear acrylic light guide panels illuminate edges of leaves



Kuzco Novel Family

- 360-degree rotatable disks
- Family of products available in linear pendant, small & large pendant, surface mount, flush mount, vanity, floor lamps
- Black finish only
- 3,000k
- Triac or ELV dimming



Lindsley Shooting Star Pendant

- 1" diameter
 - 10", 15", 24", 32" height options
- 1000 lumens (9w), 500 lumens (4.5w)
- 2700k, 3000k, 3500k, 80 or 90+ CRI
- 0-10v, ELV, 1%, 0% and DMX available
- 15-, 30-, 60-degree beam spreads
- Silver, gold, black, white; finishes are mix and match interior/exterior



Diesel Living With Lodes

- (3) additions: Flask, Vinyl, Urban Concrete
 - Vinyl: 2 sizes, wall/surface mount and suspended, 2 finishes (deep black, silver)
 - Urban Concrete: 3 sizes, 3 finishes (pink dust, tough gray, soft gray)
 - Flask: 3 shapes, 2 finishes (metallic black, mineral sand)
 - Urban Concrete & Flask can be used with cluster system canopies
- (5) renovated existing: Cage, Fork, Gask, Glass Drop, Pipe



Lodes Aile Wall Sconce

- Die-cast aluminum body reminiscent of the aileron of sports cars
- 8.26"W x 4"D
- (2) 9W LED modules, 3000k, 92 CRI, 1700 lumens
- Triac dimmable
- 4 finish options: black, white, matte champagne, lacquer red



Lodes Bugia Mega

- 31.33" x 30.11"
- 3 light sources
- 15w each, 3825 lumens, 3000k
- 4 diffuser finishes: glossy copper, chrome, gold & white

Lucifer Stellr CMJB

- Matches profile of pendant and surface mount canopies
- Compatible with ½" and ¾" EMT conduit
- 3 knockouts and top feed knockout

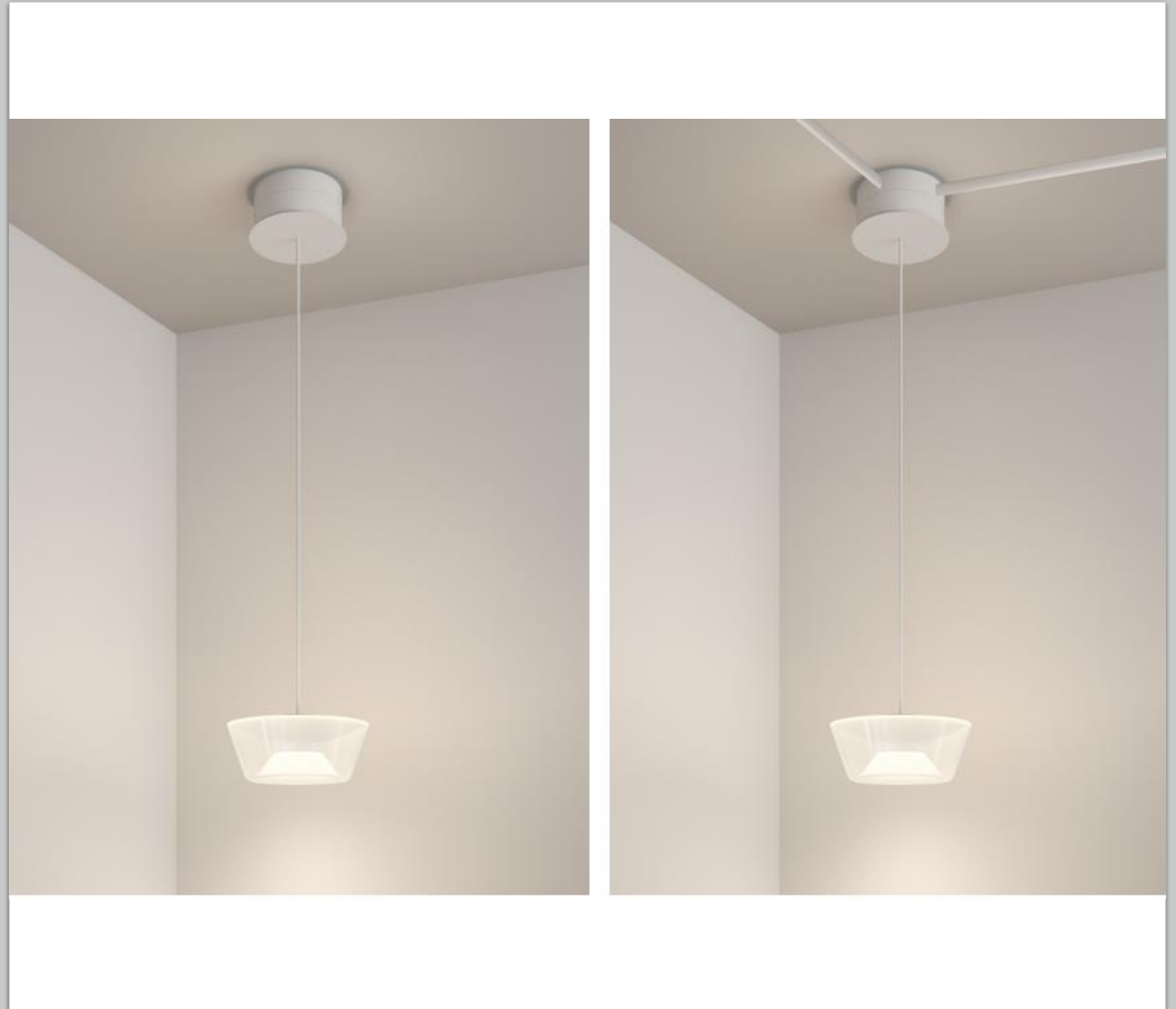

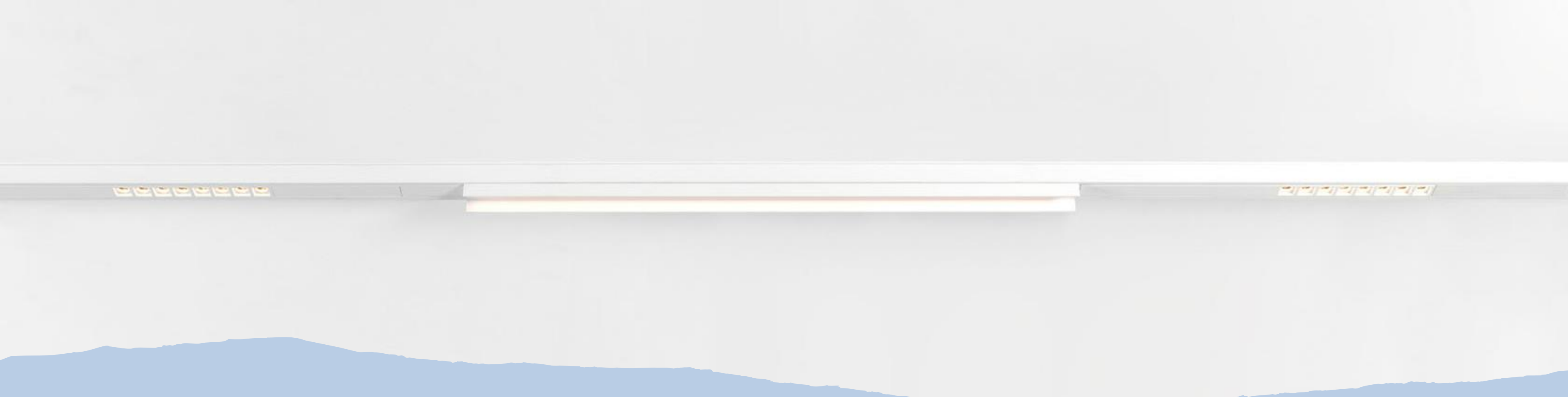

Modular Pista Expansion

- 8x (8w) and 16x (16w) linear spots
- Linear flaps
- 19.7" (10.5w)
- 39.4" (19w)
- 59.1" (27.5w)
- Mounts to Pista track profile
- 0-10v & Dali
- Standard black & white finishes

Modular Minude

- Suspended and adjustable surface mount
- 1 25/32" x 3 15/32"
- Adjustable is 360-degree rotatable with 90-degree tilt
- Up to 598 delivered lumens
- 30-degree beam (surface), 28-degree beam (suspended)
- 2700k, 3000k, 3500k
- White, black, anodized silver bronze, anodized champagne, anodized bronze, anodized black
- Remote driver





Modular Smart 1.9 Accessory

- Accessory that acts as low voltage electrical connection box
- Allows for mounting without a typical j-box (with remote mounted driver)
- Allows (2) fixtures connection to (1) remote driver
- Smart fixtures comprised of
 - 1. Trim (Cake, Kup, or Lotus)
 - 2. Cylinder (pendant or surface come with connection box)
 - 3. Remote driver



Sonneman Architectural Collection: Nebula

- Large scale pendants - Square pendant, Zig Zag pendant, Bar pendant, Large Square pendant
- Satin black and satin nickel finishes
- 3000k, 90 CRI with lumen range from 7,600-15,000, depending on fixture selection
- TRIAC/ELV/0-10V dimmable



Sonneman Multi-Forms Collection: Parisone

- Family of single pendant, cluster pendant, 3-light and 5-light pendants
- Satin white finish with clear or white glass shade
- Satin black finish with smoke or white glass shade
- 10' Adjustable cordsets
- 15.5" tall fixture, cluster pendant 21.25" tall fixture
- 3000k, 90CRI, TRIAC/ELV/0-10V dimmable, 7-9w LED



Visa Nacelle

- 4', 6', & 8' lengths; custom lengths in 6" increments available
- 1-3/8"W x 2-3/8"H
- 0-10V to 1%; 3000k, 3500k, 4000k, 90 CRI optional
- 4' fixture:
 - Low: 14w & 1900/2000 lumens
 - High: 30w & 3800/4000 lumens
- 6' fixture:
 - Low: 21w & 2900/3000 lumens
 - High: 45w & 5800/6000 lumens
- 8' fixture:
 - Low: 28w & 3800/4000 lumens
 - High: 60w & 7700/8000 lumens
- Remote or driver in canopy
- Concave endcaps can be ordered in contrasting finish



Visa Theo

- 1' & 2' pendants, single & double wall sconces
- 1-1/2" diameter
- 0-10V to 1%; 3000k, 3500k, 4000k, 90 CRI optional
- Pendants: 7w, 725-750 lumens
- Single wall sconce: 8w, 850-900 lumens; Double wall sconce: 15w, 1650-1750 lumens
- Acrylic rods are transparent when not illuminated; functional downlight component due to special treatment of the rod ends
- Driver in canopy or remote mount

ARCHITECTURAL



Finelite DSO Optic for HP-2

- Now available with HP-2 surface, pendant, & recessed; with exception of regressed and curves
- Subtle ribbed appearance

Focal Point Updates

- NEW acoustic colors: blush, deep water, seafoam, & limestone
- Seem 1 acoustic new distribution offerings in asymmetric & batwing
- Seem 2 Recessed Grid Mount
 - Expanded lumen output, up to 1000 lumens/ft
 - 25% wider lens
 - NEW batwing (BW) & asymmetric (AS) lenses

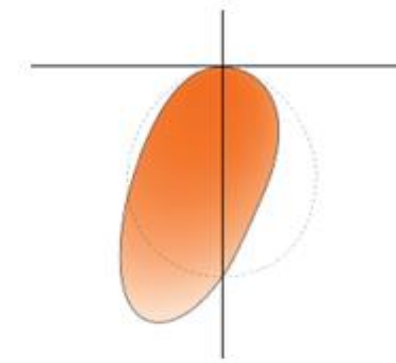

Asymmetric Lens

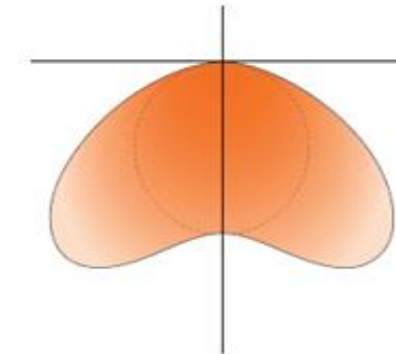

Batwing Lens



Blush



Deep Water



Seafoam



Limestone

Focal Point Seem 1 Continuous Point Source



- Recessed, surface, suspended (direct & indirect/direct)
- Spaced at 6" or 12" intervals
- 250-450 lumens per point source
- NFL (21-degree), FL1 (28-degree), FL2 (42-degree), WFL (53-degree)



Focal Point Seem 1 Lit Endcaps

- End caps welded to housing
- Offered with suspended, surface, & wall mount
- Direct or Direct/Indirect
- Adds 2" to overall fixture length





Litelab Fully Recessed Emergency Downlights

- Fully recessed emergency downlight that fits inside Litelab BusRun
- Designed for use in ceiling heights between 10' & 25'
- 4.5"L x $\frac{3}{4}$ "W

Q-Tran EMBD

- Flanged extrusion for recessed applications
- 1.14" wide with flange
- Standard lenses & optical lenses but also available as rigid encapsulated fixture
- Multiple beam spreads: 12, 14, 20, 30, 45, 60 degree
- Spring clip or magnet clip mounting
- Satin finish only

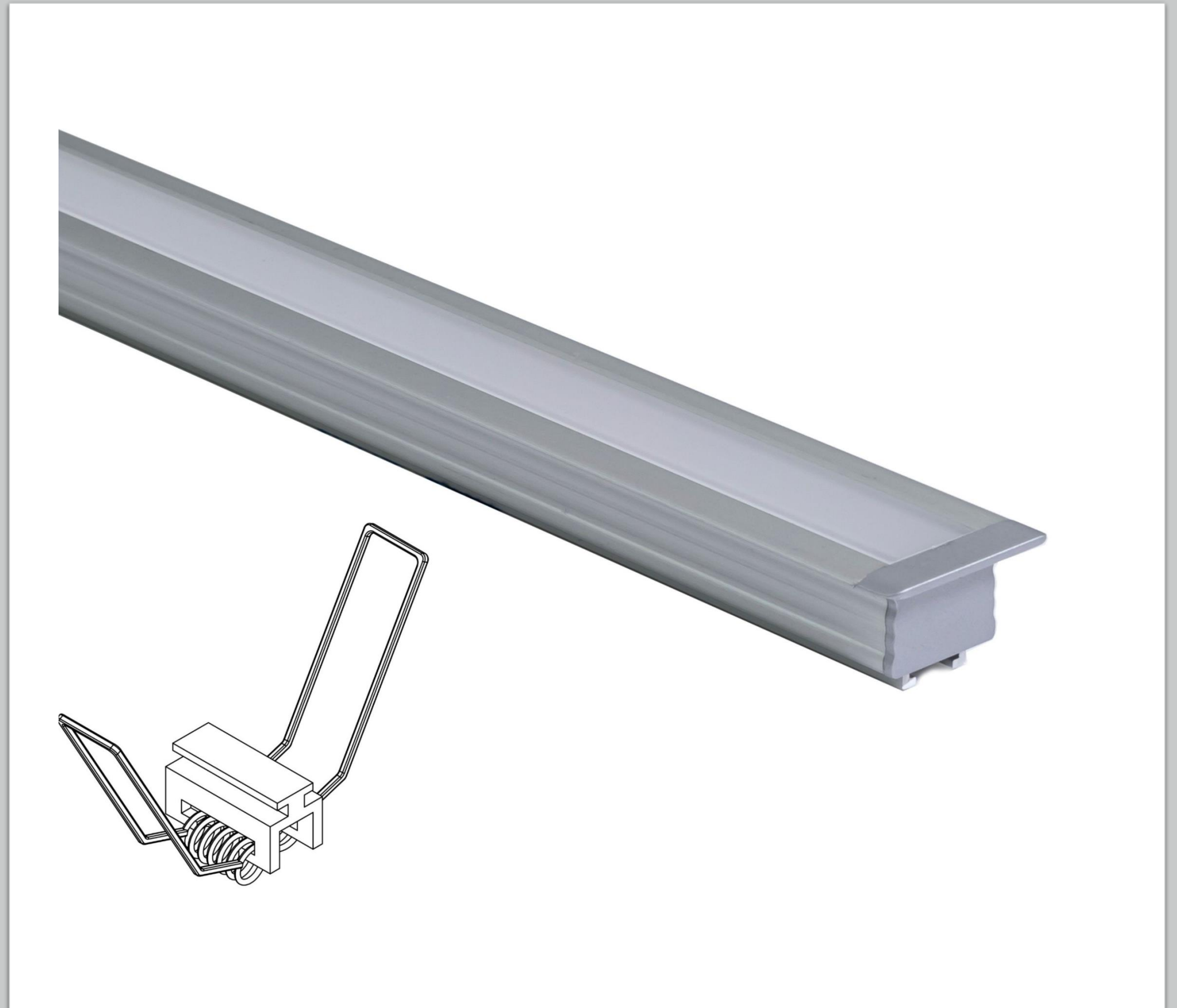

Q-Tran LALO & VEVE Fixtures



- Lalo: direct & indirect surface mount applications
 - Flat: clear, frosted, polar, & diffused lenses, 1.5w-6w/ft, available with all strip series, dry, damp, & wet
 - Optics: extruded optical lens in 17-degree beam, 1.5w-6w/ft, available with all strip series, dry, damp, & wet
 - Encapsulated: fully encapsulated fixture with IP67 rating, 17-degree beam, 1.5w-6w/ft
- Veve: flush corner applications
 - Flat: clear, frosted, polar, & diffused lenses, 1.5w-9w/ft, available with all strip series, dry, damp, & wet
 - Optics: extruded optical lens in 20- or 40-degree beam, 1.5w-9w/ft, dry, damp, & wet

Q-Tran RGBW- HE24/4.0 & 8.0

- 21 diodes per 2" cut point – 7 RGB & 14 static white
- 4 watt available in dry, damp, wet, or encapsulated; 8 watt available in dry rated only
- 2700k or 3000k
- 4w: 2700k=89 lumens/ft, 3000k=94 lumens/ft; 8w: 2700k=248 lumens/ft, 3000k=285 lumens/ft

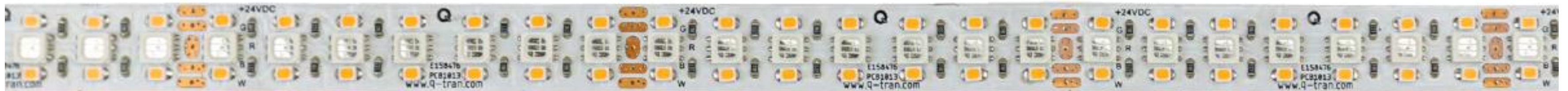

Q-Tran TORQ Fixtures

- TORQ-Flat
 - Clear, frosted, polar, diffused lens options
 - SW, SW-HE, SW-HE+, SWIA, DW, DW-HE, SC, RGB, RGBW-HE
- TORQ-Optics
 - Extruded optical lens in 12-degree or 40-degree beam spread
 - SW, SW-HE, SW-HE+, SWIA, DW, DW-HE, SC, RGB
- TORQ-Encapsulated
 - Fully encapsulated fixture in polyurethane
 - SW, SW-HE, DW, DW-HE, SC, RGB, RGBW-HE
- 1.5w-9w HE
- Satin, black, & bronze finish options
- SW, SW-HE, DW-HE are JA8 listed



40-Degree Optic Q-Tran VERS-05

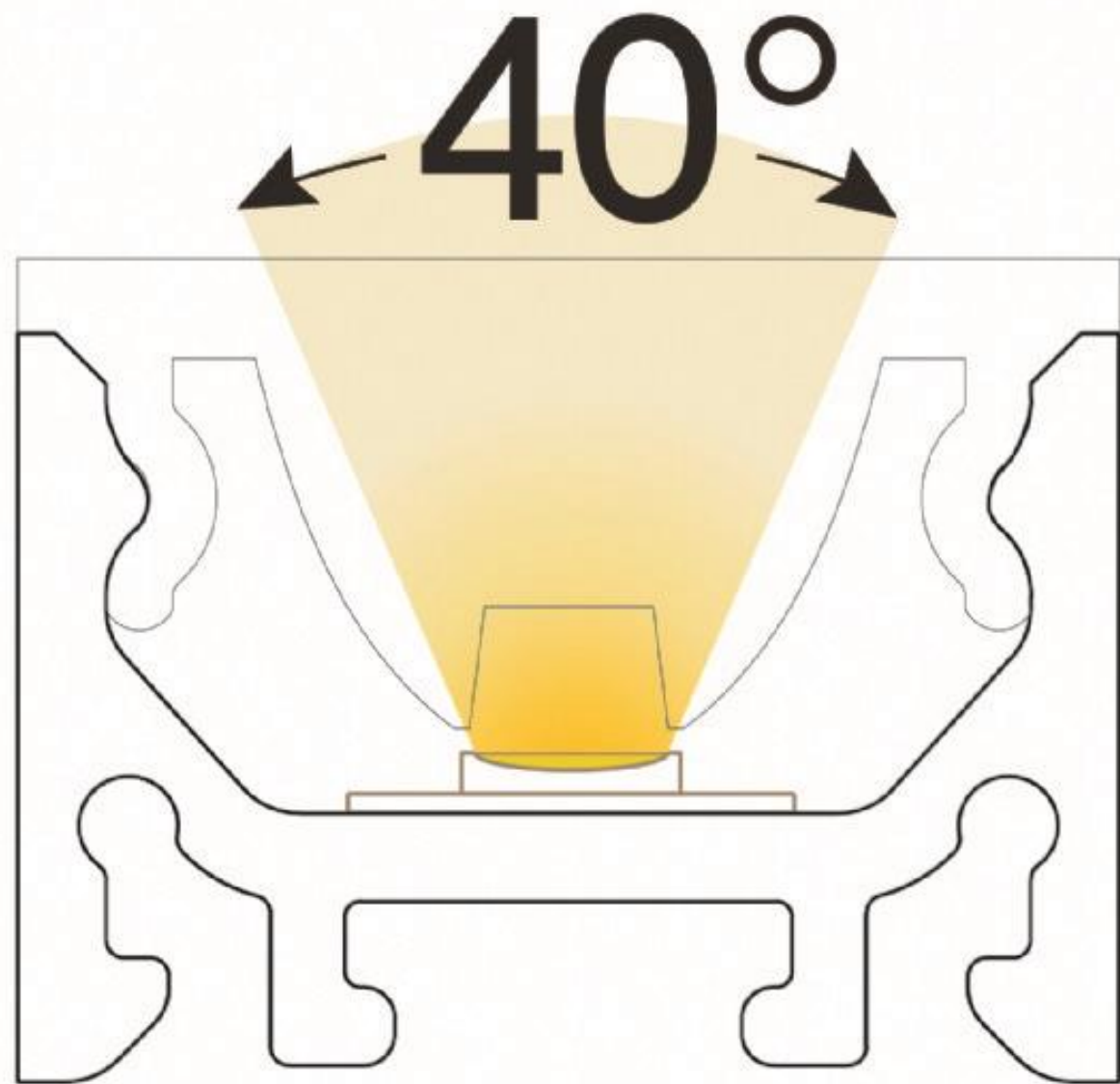

- Now offered in addition to standard 50-degree
- Dry rated only
- Up to 9w/ft
- 2000k-4000k available as well as static color, RGB & warm dim
- Satin, black, bronze, & white
- SW & HE fixtures are JA8 listed



Q-Tran VERS-09

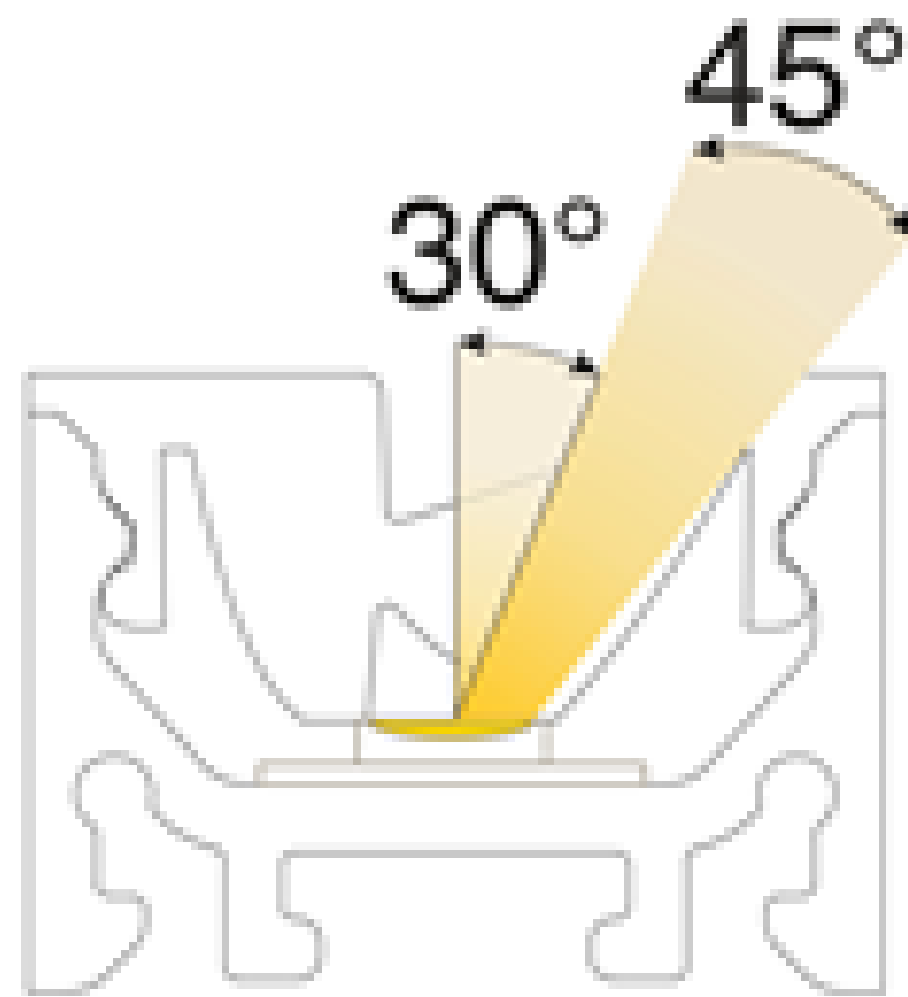

Profile

- Asymmetric lens
- 45-degree beam that is shifted 30-degrees off center
- Available with SW, SW-HE, DW, SC, RGB
- 1.5w-9w HE; dry rated only
- Satin, black, bronze, & white finishes
- SW & HE are JA8 listed
- Concealed clip & magnet clip mounting





Vode ZipTwo Integration with Armstrong DynaMax

- Attaches via DynaMax boss channel for Armstrong ceilings for data centers
- DynaMax clip installs inline with DynaMax threaded beam
- Layout guide available online
- Available for all ZipTwo profiles





Zumtobel Vaero

- Direct/indirect 1x4
- 3700 or 5400 lumens
- Available with tunable white
- Transparent panels with Side Lit technology via concealed LED in center bar
- Black, white & silver finishes
- Battery backup available

Zumtobel Icos NG



- 5"w, continuous rows made of 4' units
- 360 degrees of light
- Micropyramidal Optic (MPO +)
- 860 or 1000 lumens per foot
- Compatible with TECTON Trunking, pendant or surface mounted
- Black, bronze, silver, & white finishes
- EM options available

DOWNLIGHTS & TRACK



Bruck LX Series

- 4" Performance spec-grade spots & cylinders
- 9 track system mountings including SMARTrack, monopoint spots & pendants, surface mount, & conduit j-box cover with knockouts
- Static white, sunlike, warm dim, tunable white, RGBW, Lumentix; multiple control protocols available
- 10-, 15-, 25-, 45-, 60-degree, batwing, asymmetric, & elliptical (30-degree x 60-degree)
- Multiple media and glare control accessories available
- Static white up to 3300 lumens



Lucifer 10-Degree Beam Spread

- Narrow 10-degree optic
- Available across most product lines
- Available with all driver options
- 80, 90, 97 CRI and 2700k, 3000k, 3500k, 4000k

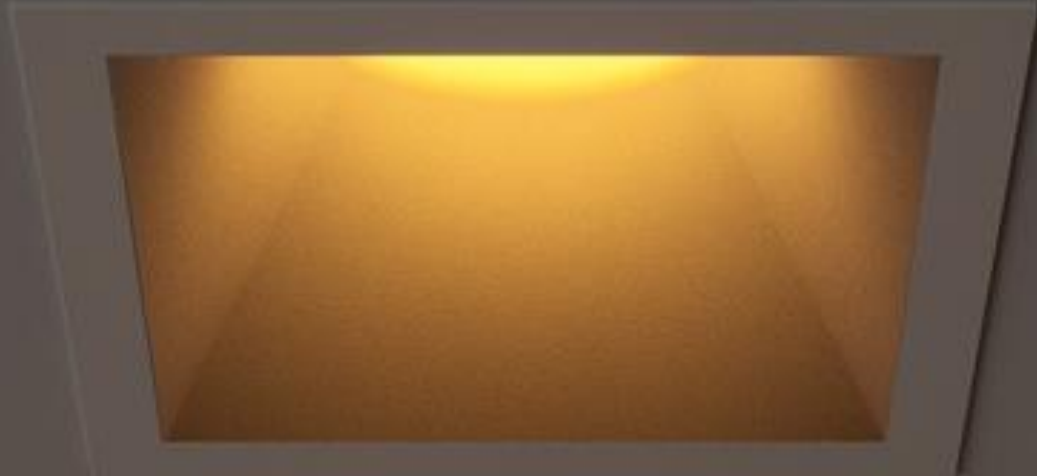

Lucifer 2200k Offering

- Available for all downlights, track heads and surface mounted products
- Available with all driver options and beam spreads (except the new 10-degree)
- 800-1200 lumen packages only
- Only available with 90C CRI fixtures

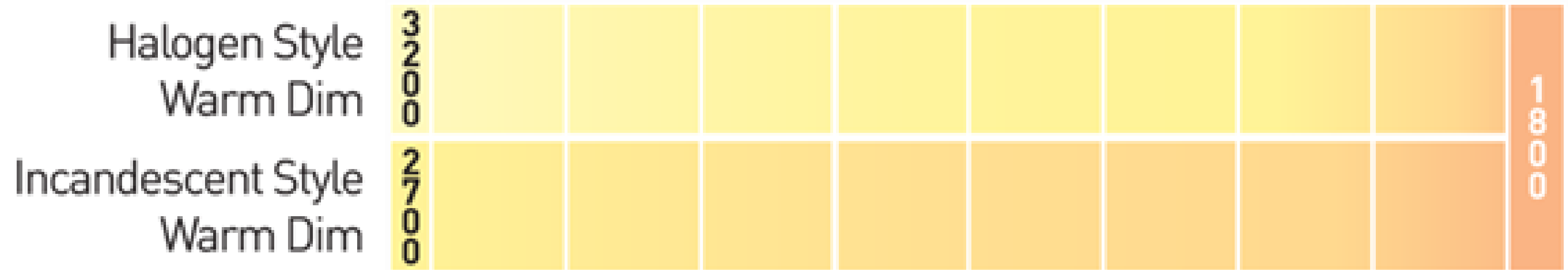

Lucifer Incandescent Warm Dim

- 2700k-1800k
- Available for all downlights, cylinders, squilinders, and track heads
- 90C CRI only – maintains through dimming range
- Available with most driver options
- Available with same beam spreads and alternate effects devices as halogen warm dim



Williams Architectural Cylinder Collection

- Family includes 4", 6.5", 8" round & square
- Wall, cable, pendant, surface, power cord, & AC mounting options
- D & I/D options
- Dim-to-warm, PoE, tunable white (6.5" & 8" only)
- Indoor only
- Optional colored power cords available

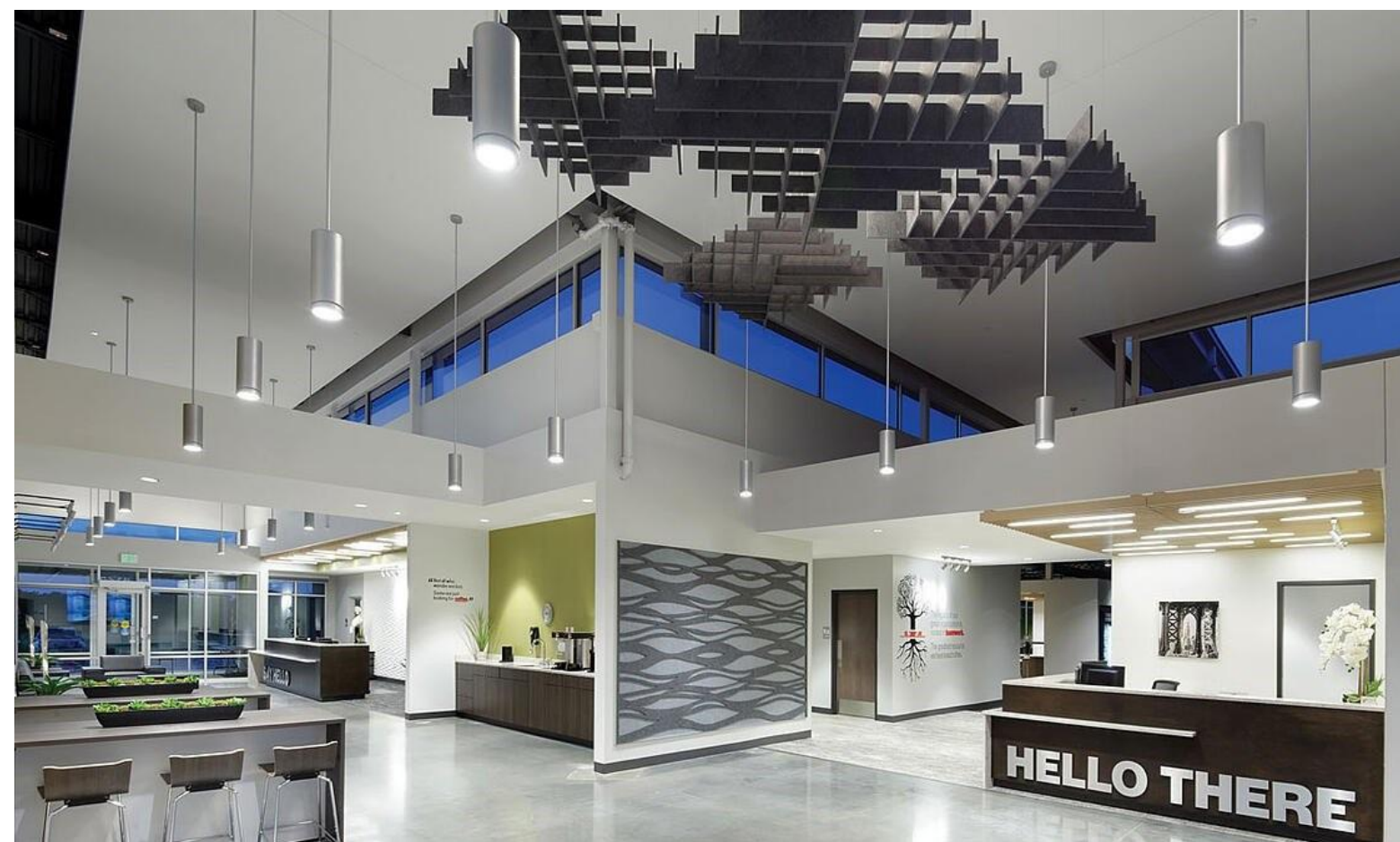

SPECIALTY



Electric Mirror Brilliance

- Round (30", 36") and oval (24" x 36")
- Matte black finish standard, silver available
- JA8 when specified with dimming
- 100+ minimum order quantity



Meteor Bolt

- IP 65 rated, outdoor & natatorium ratings optional
- 120-degree range of motion at both the bracket and lighthead level
- 60-560 watts; up to 68,000 lumens
- Beam Angle: 15°, 30°, 60°, 80° and 100° (with diffuser)
- Tunable white & W+RGB available
- Available in Ground, Surface, Wall, and Pole mount option
- DLC Premium and DLC listed



OUTDOOR

Bega Wooden System Bollards

- Round and square
 - Round: 3 sizes – 25 7/8", 32 1/8" & 34 5/8"
 - Square: 2 sizes – 32 1/8" & 34 5/8"
- 9 wood finish options
- Available with any of Bega's 11 system bollard heads



Bega Façade Floodlights



- In-ground & on-ground
- Standard finishes; 2700k, 3000k, 3500k, 4000k
- In-ground: 11 ¼" diameter, 24.6w, 2330 lumens
- On-ground: 10 3/8" x 2 7/8", 29.1w, 4160 lumens

BK Square Delta Star

- 7W; up to 525 delivered lumens
- 13°, 15°, 23°, or 31° optics
- Standard 360SL knuckle
- No visible set screws
- 6 cap styles
- Water-tight Anti-Siphon Plug technology



BK Denali Integral Expansion



- Now also available in 21w
- 90 CRI available for both 13w & 21w-JA8 compliant
- New 3500k available, in addition to standard 2700k, 3000k, & 4000k
- Denali Integral now available as standard option for Surface Downlight, Recessed Uplight, & Sign Star Styles A, B, C, F, G, L



Wagner Bantam Square

- Designed for flat post or surface mounting
- 116 lumens per watt
- 2700k, 3000k, 4000k, 5000k as well as static color blue, green, red, and amber
- 16-, 23-, 46-, 70-, 94-degree beam spreads @ +10-degree nadir
- IK10 impact rating
- 0-10v dimming driver standard but Dali, DMX also available
- Options for driver include made in USA units, additional wattages, and NEMA 4X enclosures

Wagner Lumenpod 30

- Post mounted flush with 1.90" posts
- 116 lumens per watt
- 2700k, 3000k, 4000k
- 70-degree beam spread @ +35-degree nadir
- IK10 impact rating
- 0-10v dimming driver standard but Dali, DMX also available
- Options for driver include made in USA units, additional wattages, and NEMA 4X enclosures



Index

Decorative

[Flora Collection from Alora](#)
[Kuzco Novel Family](#)
[Lindsley Shooting Star Pendant](#)
[Diesel Living with LODES](#)
[LODES Aile Wall Sconce](#)
[LODES Bugia Mega](#)
[Lucifer Stellr CMJB](#)
[Modular Pista Linear Flaps](#)
[Modular Pista Spots](#)
[Modular Minude](#)
[Modular Smart 1.9 Accessory](#)
[Sonneman Nebula](#)
[Sonneman Parisone](#)
[Visa Nacelle](#)
[Visa Theo](#)

Architectural

[Finelite DSO Optic for HP-2](#)
[Focal Point Seem 1 Continuous Point Source](#)
[Focal Point Seem 1 Lit Endcaps](#)
[Litelab Fully Recessed Emergency Downlights](#)
[Q-Tran EMBD](#)
[Q-Tran LALO](#)
[Q-Tran RGBW-HE24/4.0 & 8.0](#)
[Q-Tran TORQ Fixtures](#)
[Q-Tran VERS-05](#)

[Q-Tran VERS-09](#)

[Q-Tran VEVE](#)

[Vode ZipTwo Armstrong DynaMax](#)

[Zumtobel Icos NG](#)

[Zumtobel Vaero](#)

Downlight and Track

[Bruck LX Series](#)

[Lucifer Lighting Updates](#)

[Williams Architectural Cylinder Collection](#)

Specialty

[Electric Mirror Brilliance](#)

[Meteor Bolt](#)

Outdoor

[Bega Wood System Bollards](#)

[Bega Façade Floodlights](#)

[BK Denali Integral Expansion](#)

[BK Square Delta Star](#)

[Wagner Bantam Square](#)

[Wagner Lumenpod 30](#)

